

## Introduction

### ► Feature

Line pull:	5,443 kg / 12,000 lb wire rope first layer
Wire rope:	9.5 mm × 25 m galvanized aircraft A7 × 19
Brake:	Full load holding proprietary cone brake.
Clutch:	Lift and turn the T-Bar to activate free spool
Control:	Handheld pendant switch

### ► Unpacking

- Winch assembly..... 1 pc
- Separate solenoid box..... 1 pc
- Remote control..... 1 pc
- Wire rope with hook..... 1 pc
- Roller fairlead..... 1 pc
- 1.8 m 2 gauge battery lead..... 1 pc

### ► Read this manual carefully

Carefully read and understand this manual before operating the winch. Careless winch operation may result in personal injury, danger to others and/or damage to property

## Installation

Before using the winch ensure all electrical components are in good condition and all connections are sound.

### ► Winch and roller fairlead mounting

- It is important that the winch is mounted on a flat and hard surface or mounting channel in order to make sure the motor, drum and gearbox housing are aligned correctly.
- Neither the roller fairlead or the solenoid box mount to the winch directly.

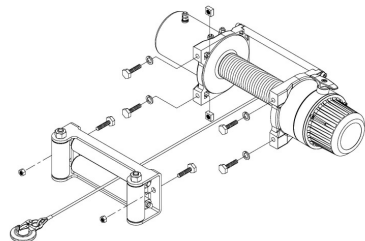

- The wire rope shall be wound in an under-wound orientation only.
- Four (4) M10 x 1.50 pitch 8.8 grade high tensile steel bolts must be used in order to sustain the loads imposed on the winch mounting.

## ► Wiring Diagram

Attach the black lead firmly to the negative (–) battery terminal and red lead to the positive (+) battery terminal. The voltage drop for the winch motor must not exceed 10% of the nominal voltage of 12/24vdc.

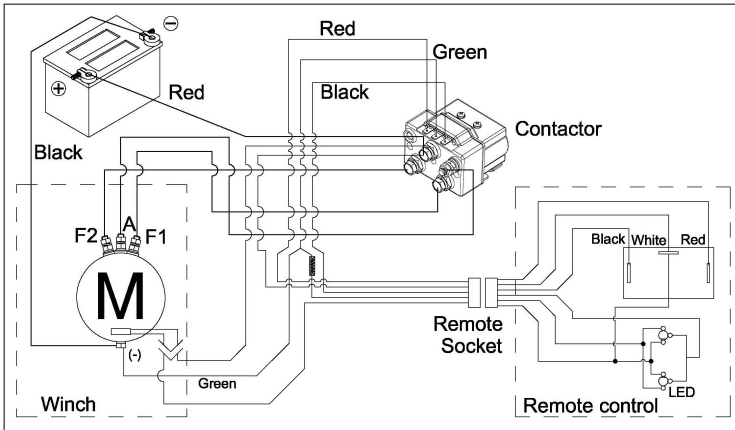

## ► Correct method to tighten the motor & contactor nuts

1. Hold the lower nut on the stud and tighten the upper nut clockwise.
2. The torque setting for the nut is 124 lb-in.

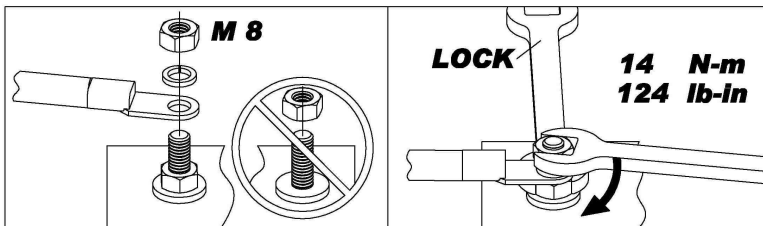

## Warning

- The winch is not to be used for transporting or lifting of personnel.
- The rated line pull shown is based on the first layer of rope on the drum.
- The rope shall remain with at least 5 wraps on the drum at all times

## **Parts List**

Item	No.	Description	Part No.	Qty
1		Motor 12V	881294	1
		Motor 24V	881295	
2		Tie bar kit	880003	2
3		Motor support rack	880004	1
4		Motor coupling	880005	1
5		Drum bushing	880006	2
6		Drum kit	881521	1
7		Gearbox support rack	881866	1
8		Grounding lead	880009	1
9		Wire rope w/hook	881522	1
10		1 <sup>st</sup> shaft	881523	1
11		3 <sup>rd</sup> ring gear kit	881524	1
12		3 <sup>rd</sup> stage carrier	881525	1
13		3 <sup>rd</sup> bushing	880014	1
14		2 <sup>nd</sup> stage carrier	881526	1
15		1 <sup>st</sup> stage carrier	881527	1
16		1 <sup>st</sup> & 2 <sup>nd</sup> ring gear	881528	1
17		1 <sup>st</sup> pinion kit	880018	1
18		Clutch kit	881303	1
19		Gear box kit	881529	1
20		Cone brake disc kit	880021	1
21		Brake cover kit	881530	1
22		Roller fairlead	880023	1
23		Mounting hardware	880024	1
24		Remote control	880126	1
25		Handsaver strap	880026	1
26		Detachable control box 12V	881164	1
		Detachable control box 24V	881165	
26-1		Remote socket kit 12V	881373	1
		Remote socket kit 24V	881374	
26-2		Detachable control pack 12V	881400	1
		Detachable control pack 24V	881401	
27		Brake clutch base	881100	1

**Winch Assembly**

